



LEE & ASSOCIATES  
COMMERCIAL REAL ESTATE SERVICES



STONEMONT



[Click Here for Progress Photos](#)

[Click to View Property Video](#)



LEGACY  
AT ORIOLE

NOW PRE-LEASING  
Q4 2023 DELIVERY

16670 - 16680 ORIOLE ROAD, FORT MYERS, FLORIDA 33912

# SITE MAP

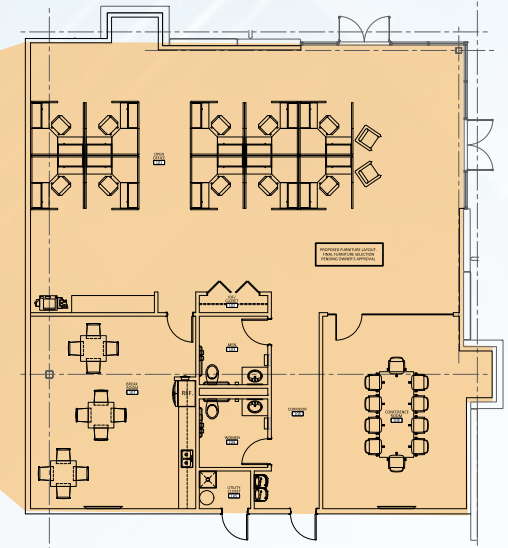
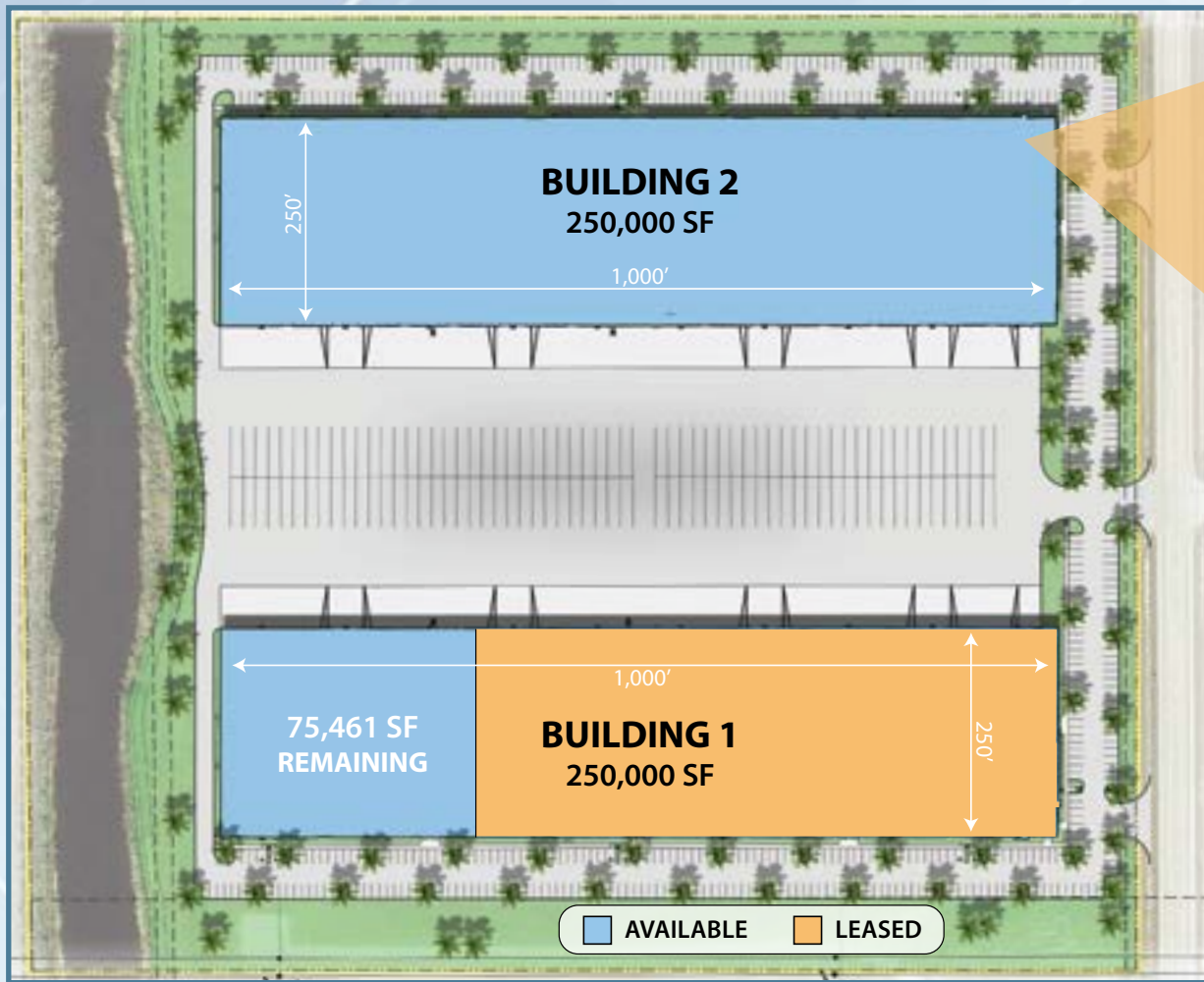

| SPECIFICATIONS         | BUILDING 1                     | BUILDING 2                                    |
|------------------------|--------------------------------|---|
| OFFICE TO SUIT         | 75,461 SF                      | OFFICE TO SUIT<br>2,922 SF                    |
| BUILDING DEPTH         | 250'                           | BUILDING DEPTH<br>250'                        |
| COLUMN SPACING         | 50' x 50'                      | COLUMN SPACING<br>50' x 50'                   |
| CLEAR HEIGHT           | 32'                            | CLEAR HEIGHT<br>32'                           |
| DOCK DOORS             | Up to 16 Dock Doors (9' x 10') | DOCK DOORS<br>Up to 43 Dock Doors (9' x 10')  |
| DRIVE - INS            | 2 Drive - In Doors (12' x 14') | DRIVE - INS<br>8 Drive - In Doors (12' x 14') |
| TRUCK COURT            | 180'                           | TRUCK COURT<br>180'                           |
| WAREHOUSE LIGHTING     | LED                            | WAREHOUSE LIGHTING<br>LED                     |
| FULLY SPRINKLERED      | ESFR                           | FULLY SPRINKLERED<br>ESFR                     |
| PARKING SPACES         | 280                            | PARKING SPACES<br>280                         |
| TRAILER PARKING SPACES | 25                             | TRAILER PARKING SPACES<br>85                  |

# CORPORATE NEIGHBORS



# SITE AERIALS

---



# CONSTRUCTION UPDATE - NOVEMBER 20, 2023





LEE & ASSOCIATES  
COMMERCIAL REAL ESTATE SERVICES



STONEMONT



**LEGACY  
AT ORIOLE**

## FOR LEASING INFORMATION PLEASE CONTACT:

---

**DEREK BORNHORST, SIOR, CCIM**

*PRINCIPAL*

239.210.7607

[dbornhorst@lee-associates.com](mailto:dbornhorst@lee-associates.com)

---

**BOB JOHNSTON, SIOR**

*PRINCIPAL*

239.210.7601

[bjohnston@lee-associates.com](mailto:bjohnston@lee-associates.com)

---

**JERRY MESSONNIER, SIOR**

*PRINCIPAL*

239.210.7610

[jmessonnier@lee-associates.com](mailto:jmessonnier@lee-associates.com)